



# Muscatine Area Geographic Information Consortium (MAGIC)

## Summary

**Parcel ID** 0921377003  
**Alternate ID** RSWMUW-0921377003  
**Property Address** 1995 SWEETLAND RD  
 MUSCATINE IA 52761  
**Sec/Twp/Rng** N/A  
**Brief Tax Description** 21-77-1W LOT 2 GORDON'S HIGHLAND ESTATES 7 PL 517-518  
 (Note: Not to be used on legal documents)  
**Deed Book/Page** 2009-05271 (8/17/2009)  
**Contract Book/Page**  
**Gross Acres** 0.00  
**Net Acres** 0.00  
**Class** R - Residential  
 (Note: This is for tax purposes only. Not to be used for zoning.)  
**District** SWMUW - SWEETLAND TWP/MUSCATINE SCH/WILTON FIRE  
**School District** MUSCATINE COMM SCHOOL



## Owner

**Deed Holder**  
 Antram Thomas F Or Deborah L  
 1995 Sweetland Rd  
 Muscatine IA 52761-8336

### Contract Holder

**Mailing Address**  
 Antram Thomas F Or Deborah L  
 1995 Sweetland Rd  
 Muscatine IA 52761-8336

## Land

**Zoning** R1-Res - Single Family Large Lot  
**Lot Area** 1.00 Acres ; 43,560 SF

## Residential Dwellings

**Residential Dwelling**  
**Occupancy** Single-Family / Owner Occupied  
**Style** 1 Story Frame  
**Architectural Style** N/A  
**Year Built** 1979  
**Exterior Material** Vinyl  
**Total Gross Living Area** 1,256 SF  
**Attic Type** None;  
**Number of Rooms** 5 above; 0 below  
**Number of Bedrooms** 3 above; 0 below  
**Basement Area Type** Full  
**Basement Area** 1,256  
**Basement Finished Area** 950 - Standard Finish  
**Plumbing** 1 Full Bath; 1 Lavatory; 1 Water Closet;  
**Central Air** Yes  
**Heat** Yes  
**Fireplaces** 1 Prefab;  
**Porches**  
**Decks** Wood Deck-Med (120 SF);  
**Additions**  
**Garages** 484 SF - Att Frame (Built 1979);

## Sales

Date	Seller	Buyer	Recording	Sale Condition - NUTC	Type	Multi Parcel	Amount
8/17/2009	ANTRAM THOMAS F & DEBORAH L	ANTRAM THOMAS F OR DEBORAH L	2009-05271	SALE BETWEEN FAMILY MEMBERS (INCLUDING EX-SPOUSES)	Deed		\$0.00
12/21/1992	FIRST NATIONAL BANK OF MUSCATINE	ANTRAM THOMAS F & DEBORAH L	368-972	FULLFILLMENT OF PRIOR YEAR CONTRACT	Deed		\$0.00
2/14/1989	FIRST NATIONAL BANK OF MUSCATINE	ANTRAM THOMAS F OR DEBORAH L	179-467	NO CONSIDERATION	Contract		\$72,000.00
2/14/1989	ANTRAM THOMAS F OR DEBORAH L	FIRST NATIONAL BANK OF MUSCATINE	179-466	NO CONSIDERATION	Deed		\$0.00

**Valuation**

	2019	2018	2017	2016	2015	2014
Classification	Residential	Residential	Residential	Residential	Residential	Residential
+ Assessed Land Value	\$20,000	\$40,000	\$40,000	\$40,000	\$40,000	\$40,000
+ Assessed Building Value	\$0	\$0	\$0	\$0	\$0	\$0
+ Assessed Dwelling Value	\$55,880	\$109,500	\$109,500	\$109,500	\$109,500	\$108,260
<b>= Gross Assessed Value</b>	<b>\$75,880</b>	<b>\$149,500</b>	<b>\$149,500</b>	<b>\$149,500</b>	<b>\$149,500</b>	<b>\$148,260</b>
- Exempt Value	\$0	\$0	\$0	\$0	\$0	\$0
<b>= Net Assessed Value</b>	<b>\$75,880</b>	<b>\$149,500</b>	<b>\$149,500</b>	<b>\$149,500</b>	<b>\$149,500</b>	<b>\$148,260</b>

**Taxation**

	2017 Pay 2018-2019	2016 Pay 2017-2018	2015 Pay 2016-2017	2014 Pay 2015-2016
+ Taxable Land Value	\$22,248	\$22,776	\$22,250	\$22,293
+ Taxable Building Value	\$0	\$0	\$0	\$0
+ Taxable Dwelling Value	\$60,905	\$62,348	\$60,910	\$60,337
<b>= Gross Taxable Value</b>	<b>\$83,153</b>	<b>\$85,124</b>	<b>\$83,160</b>	<b>\$82,630</b>
- Military Credit	\$0	\$0	\$0	\$0
<b>= Net Taxable Value</b>	<b>\$83,153</b>	<b>\$85,124</b>	<b>\$83,160</b>	<b>\$82,630</b>
x Levy Rate (per \$1000 of value)	26.70809	27.02139	28.01726	28.21553
<b>= Gross Taxes Due</b>	<b>\$2,220.86</b>	<b>\$2,300.17</b>	<b>\$2,329.92</b>	<b>\$2,331.45</b>
- Ag Land Credit	\$0.00	\$0.00	\$0.00	\$0.00
- Family Farm Credit	\$0.00	\$0.00	\$0.00	\$0.00
- Homestead Credit	(\$129.53)	(\$131.05)	(\$135.88)	(\$136.85)
- Disabled and Senior Citizens Credit	\$0.00	\$0.00	\$0.00	\$0.00
- Business Property Credit	\$0.00	\$0.00	\$0.00	\$0.00
<b>= Net Taxes Due</b>	<b>\$2,092.00</b>	<b>\$2,170.00</b>	<b>\$2,194.00</b>	<b>\$2,194.00</b>

**Tax History**

Year	Due Date	Amount	Paid	Date Paid	Receipt
2017	March 2019	\$1,046	Yes	3/27/2019	173720
	September 2018	\$1,046	Yes	10/1/2018	
2016	March 2018	\$1,085	Yes	3/19/2018	285037
	September 2017	\$1,085	Yes	10/2/2017	
2015	March 2017	\$1,097	Yes	3/28/2017	253467
	September 2016	\$1,097	Yes	9/30/2016	
2014	March 2016	\$1,097	Yes	3/28/2016	221284
	September 2015	\$1,097	Yes	9/30/2015	

**Sketches**

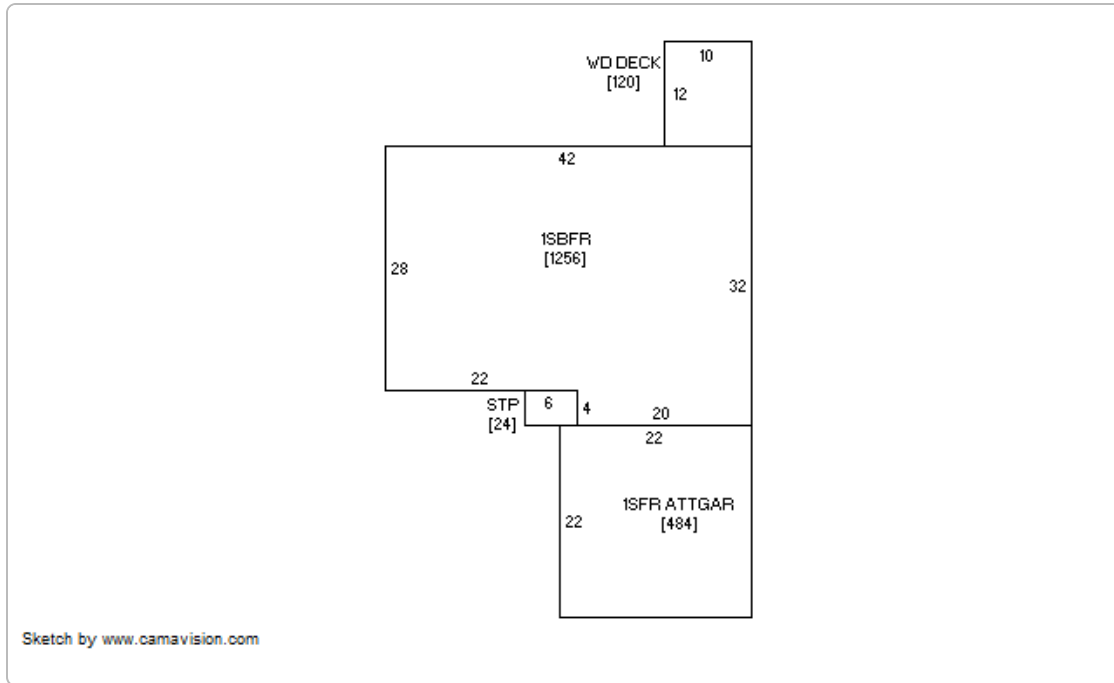

### Photos



### Appraisal Abbreviations

Click [here \(172 KB .pdf\)](#) or [here \(88 KB .doc\)](#) for explanations of the Muscatine County Appraisal Abbreviations used on building sketches.

No data available for the following modules: Commercial Buildings, Agricultural Buildings, Yard Extras, Permits, Tax Sale Certificates.

THE INFORMATION IN THIS WEB SITE REPRESENTS CURRENT DATA FROM A WORKING FILE WHICH IS UPDATED REGULARLY. INFORMATION IS BELIEVED RELIABLE, BUT ITS ACCURACY CANNOT BE GUARANTEED. NO WARRANTY, EXPRESSED OR IMPLIED, IS PROVIDED FOR THE DATA HEREIN OR ITS USE.

User Privacy Policy  
GDPR Privacy Notice

Last Data Upload: 8/1/2019, 10:01:32 PM

Developed by  
 Schneider  
GEOSPATIAL

Version 2.2.36